



Your Sign Here

270 Storke Rd., Ste. D
Goleta, CA 93117

Retail Space For Lease

±1,040 SF | \$2.95 SF NNN (\$0.54)



FOR LEASE :: ±1,040sf RETAIL SPACE

270 STORKE RD., STE. D | GOLETA, CA 93117

PROPERTY BRIEF

Great retail location in Goleta with signage facing Storke Rd. Nearby tenants include Costco, K-Mart, Home Depot, Rusty's Pizza, Chipotle and Bicycle Bob's. Close to the 101 freeway, UCSB, Girsh Park, Dos Pueblos High School and the heart of Goleta's residential population. Located across the street from a major regional shopping center. Frontage has the highest traffic count in the county. Available immediately. Contact Listing agent for further details.

Lease Rate :: \$2.95/SF NNN (\$0.54)

Space Size :: ±1,040 SF

Zoning :: C-2

Parking :: Common

HVAC :: Yes

Restrooms :: Private

Floor :: First

CPI :: Annual



The information provided here has been obtained from the owner of the property or from other sources deemed reliable. We have no reason to doubt its accuracy, but we do not guarantee it.

Rob Hambleton
805.879.9611
rhambleton@radiusgroup.com
CA Lic. 01858350

Michael Chenoweth
805.879.9608
mchenoweth@radiusgroup.com
CA Lic. 01213196



FOR LEASE :: ±1,040sf RETAIL SPACE

270 STORKE RD., STE. D | GOLETA, CA 93117

University of California,
Santa Barbara

K-Mart

Storke Rd.

Hollister Ave.

Home Depot

Staples

Sports Authority

Camino Real Marketplace

Camino Real Cinemas

Costco

Best Buy

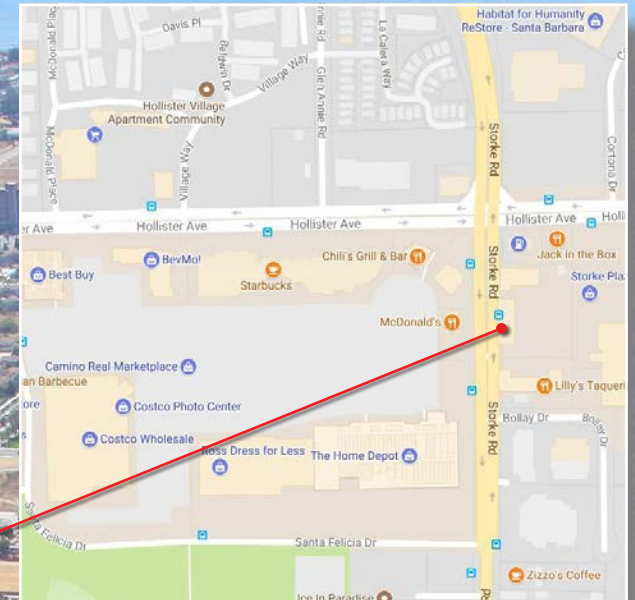

The information provided here has been obtained from the owner of the property or from other sources deemed reliable. We have no reason to doubt its accuracy, but we do not guarantee it.

Rob Hambleton
805.879.9611
rhambleton@radiusgroup.com
CA Lic. 01858350

Michael Chenoweth
805.879.9608
mchenoweth@radiusgroup.com
CA Lic. 01213196



FOR LEASE :: ±1,040sf RETAIL SPACE

270 STORKE RD., STE. D | GOLETA, CA 93117

270 Storke Rd., Ste. D | First Floor

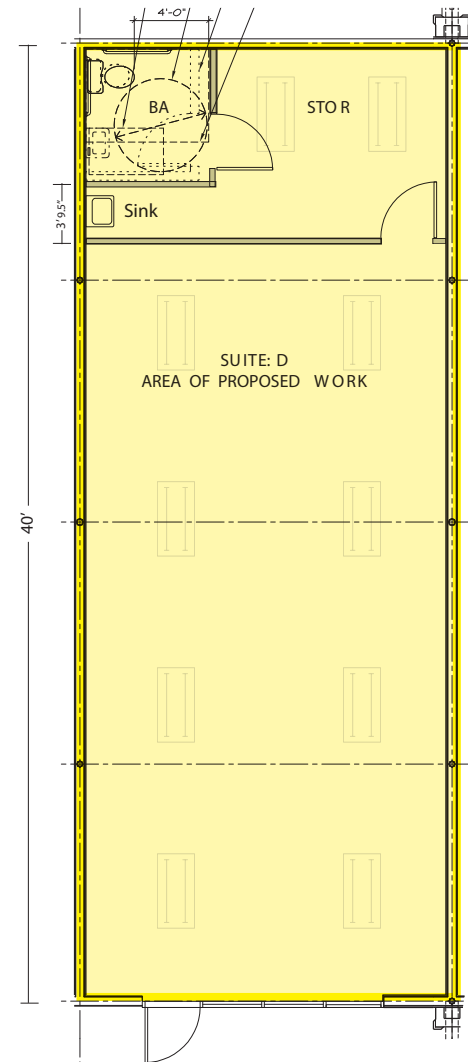

FLOOR PLAN

Not to Scale

The information provided here has been obtained from the owner of the property or from other sources deemed reliable. We have no reason to doubt its accuracy, but we do not guarantee it.

Rob Hambleton
805.879.9611
rhambleton@radiusgroup.com
CA Lic. 01858350

Michael Chenoweth
805.879.9608
mchenoweth@radiusgroup.com
CA Lic. 01213196



FOR LEASE :: ±1,040sf RETAIL SPACE

270 STORKE RD., STE. D | GOLETA, CA 93117

PROPERTY PHOTOS



The information provided here has been obtained from the owner of the property or from other sources deemed reliable. We have no reason to doubt its accuracy, but we do not guarantee it.

Rob Hambleton
805.879.9611
rhambleton@radiusgroup.com
CA Lic. 01858350

Michael Chenoweth
805.879.9608
mchenoweth@radiusgroup.com
CA Lic. 01213196

